



# FOR STARTERS



PCM  
£1,175 PCM

## MAIN COURSE

A lovely two bedroom semi-detached house within easy walking distance of the town centre.

The downstairs comprises of a bright living room with feature fireplace, leading to the dining room which has a patio door leading to the back garden. There is a modern kitchen which comes with an all-in-one cooker, and freestanding fridge/freezer. A washing machine is also provided which is situated in the outbuilding.

Upstairs is a spacious master bedroom and a second good sized double bedroom. In between the two bedrooms is a modern bathroom with a large bath and separate shower cubicle.

The property also comes with a good sized, easy to maintain rear garden.

Available the 1st of August.



# LOCATION

Please see Tenancy Information under the Lettings heading on the toolbar on our website.

## KEY INGREDIENTS



Tenure



Council Tax  
Band - B



EPC  
Band - D



TBC



Heating system  
TBC



TBC

WHY NOT TAKE  
A LOOK INSIDE?  
GIVE US A CALL  
01789 414222



### Ground Floor

Approx. 33.4 sq. metres (359.4 sq. feet)

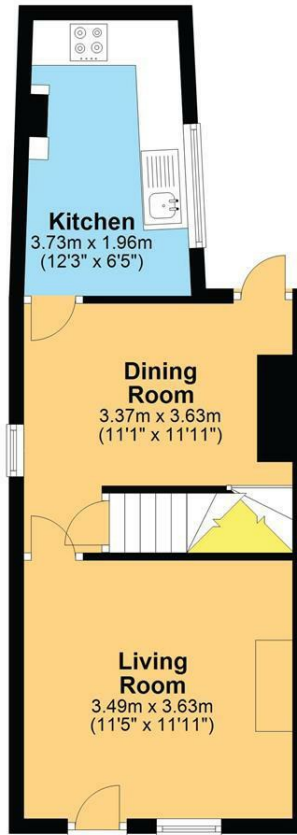

### First Floor

Approx. 33.4 sq. metres (359.2 sq. feet)



### Basement

Approx. 9.1 sq. metres (97.6 sq. feet)

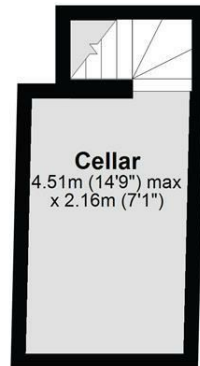

Total area: approx. 75.8 sq. metres (816.2 sq. feet)

DISCLAIMER - Floor plans shown are for general guidance only. Whilst every attempt has been made to ensure that the floorplan measurements are as accurate as possible, they are for illustrative purposes only.

**FOR MORE INFO AND  
TO SEE OUR OTHER  
LOVELY PROPERTIES  
CHECK OUT OUR WEBSITE**

**MOVEWITHEDWARDS.CO.UK**

**HAVE YOU GOT  
A PROPERTY  
TO SELL?  
WE'D LOVE TO  
HAVE A CHAT  
01789 414222**

**DID YOU KNOW WE ALSO  
DO MORTGAGES.  
FOR FREE ADVICE  
SPEAK TO  
ONE OF OUR  
CONSULTANTS**

