



FOR STARTERS



PCM
£850 PCM

MAIN COURSE

Spacious unfurnished ground floor one bedroom apartment in the popular Hamlet Way development.

One allocated parking space. Through the front door in to large sitting room which has laminated wood flooring, semi-open plan fitted kitchen with electric oven and hob, free standing fridge freezer, microwave and space for washing machine. Good sized double bedroom with large fitted wardrobes. Bathroom with power shower over bath.

Available 9th July



LOCATION

Please see Tenancy Information under the Lettings heading on the toolbar on our website.



KEY INGREDIENTS



Tenure



Council Tax
Band - B



EPC
Band - D



TBC



Heating system
TBC



TBC

WHY NOT TAKE
A LOOK INSIDE?
GIVE US A CALL
01789 414222

Ground Floor

Approx. 49.8 sq. metres (535.7 sq. feet)

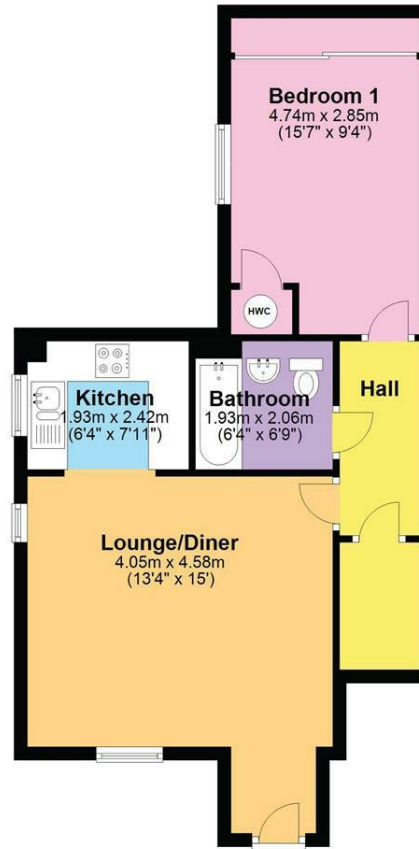

Total area: approx. 49.8 sq. metres (535.7 sq. feet)

DISCLAIMER - Floor plans shown are for general guidance only. Whilst every attempt has been made to ensure that the floorplan measurements are as accurate as possible, they are for illustrative purposes only.

**FOR MORE INFO AND
TO SEE OUR OTHER
LOVELY PROPERTIES
CHECK OUT OUR WEBSITE**

MOVEWITHEDWARDS.CO.UK

**HAVE YOU GOT
A PROPERTY
TO SELL?
WE'D LOVE TO
HAVE A CHAT
01789 414222**

**DID YOU KNOW WE ALSO
DO MORTGAGES.
FOR FREE ADVICE
SPEAK TO
ONE OF OUR
CONSULTANTS**

