



FOR STARTERS



PCM
£1,550 PCM

MAIN COURSE

****To Let - Available from 1st September 2025****

A well-presented three-bedroom town house located south of the river, offering spacious and practical accommodation across three floors.

The ground floor includes a fully fitted kitchen with integrated appliances, a generous living/dining room with doors opening onto a private, low-maintenance patio garden, and a downstairs cloakroom.

Upstairs, there are three double bedrooms, including a master suite with its own ensuite shower room and dressing area, along with a modern family bathroom.

Additional features include a garage, off-road parking for one car, and an easily maintained rear garden.

Offered unfurnished and available from 1st September 2025.
Sorry no pets or smokers.



LOCATION

Please see Tenancy Information under the Lettings heading on the toolbar on our website.

KEY INGREDIENTS



Tenure



Council Tax
Band -



EPC
Band - C



TBC



Heating system
TBC



TBC

WHY NOT TAKE
A LOOK INSIDE?
GIVE US A CALL
01789 414222



8 Feldon Way, Stratford Upon Avon

Total Approx. Floor Area 108.09 Sq.M. (1163 Sq.Ft.)

Whilst every attempt has been made to ensure the accuracy of the floor plan contained here, measurements of doors, windows, rooms and any other items are approximate and no responsibility is taken for any error, omission, or mis-statement. This plan is for illustrative purposes only and should be used as such by any prospective purchaser. The services systems and appliances shown have not been tested and no guarantee as to their operability or efficiency can be given.

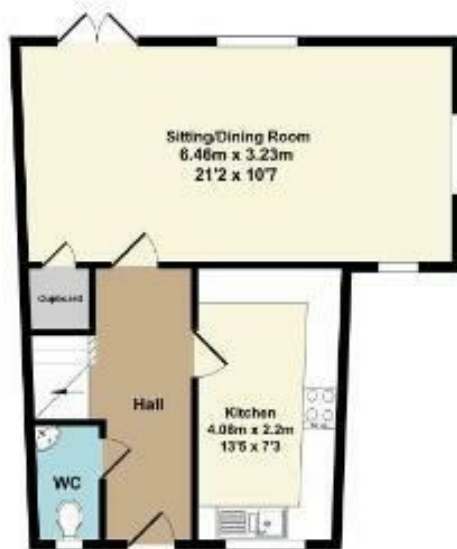

Ground Floor
Approx. Floor
Area 39.43 Sq.M.
(424 Sq.Ft.)

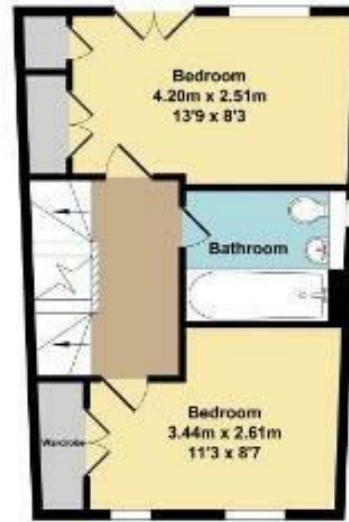

1st Floor
Approx. Floor
Area 34.33 Sq.M.
(370 Sq.Ft.)



2nd Floor
Approx. Floor
Area 34.33 Sq.M.
(370 Sq.Ft.)

**FOR MORE INFO AND
TO SEE OUR OTHER
LOVELY PROPERTIES
CHECK OUT OUR WEBSITE**

MOVEWITHEDWARDS.CO.UK

**HAVE YOU GOT
A PROPERTY
TO SELL?
WE'D LOVE TO
HAVE A CHAT
01789 414222**

**DID YOU KNOW WE ALSO
DO MORTGAGES.
FOR FREE ADVICE
SPEAK TO
ONE OF OUR
CONSULTANTS**

