



FOR STARTERS



OFFERS OVER
£350,000

MAIN COURSE

****Stunning 3-Bedroom Home Within Walking Distance to Town****

Nestled in a highly sought-after location just a short stroll from the town centre, this beautifully presented three-bedroom home offers the perfect blend of comfort, style, and convenience.

As you step through the front door, you are welcomed by a spacious entrance hall with a staircase positioned directly ahead, creating an inviting and airy atmosphere. All rooms lead off from here, including a well-placed downstairs WC and a separate storage cupboard—ideal for keeping everyday essentials neatly tucked away.

To the right of the hall, you'll find a cosy living room featuring a charming walk-in bay window, filling the space with natural light and providing the perfect spot for relaxation. Elegant glass double doors connect this room to the heart of the home—an impressive open-plan kitchen, living, and dining area. Designed by the current owners, this stunning space is perfect for modern living, whether you're entertaining guests or enjoying a quiet family meal. The kitchen boasts a well-thought-out layout, while the adjoining utility space offers added convenience. Double doors open directly onto the south-facing garden.

Upstairs, there are three well-proportioned bedrooms, all exuding warmth and comfort. The two double bedrooms provide generous space for furnishings, while the single bedroom is ideal as a child's room, home office, or guest space. All bedrooms are serviced by a



modern main bathroom.

Outside, the private south-facing garden is designed for low maintenance, offering a peaceful retreat to enjoy long summer evenings.

With its prime location, beautifully designed interiors, and thoughtful layout, this property is a rare find. An early viewing is highly recommended to fully appreciate all that it has to offer.



KEY INGREDIENTS



Tenure
Freehold



Council Tax
Band - C



EPC
Band - C
(Expired 2023)



South West Facing



Mains Services



Gas Central Heating



WHY NOT TAKE
A LOOK INSIDE?
GIVE US A CALL
01789 414222

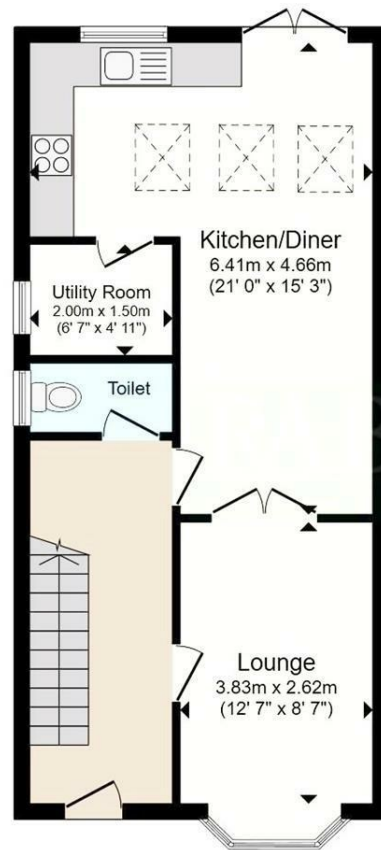

Ground Floor

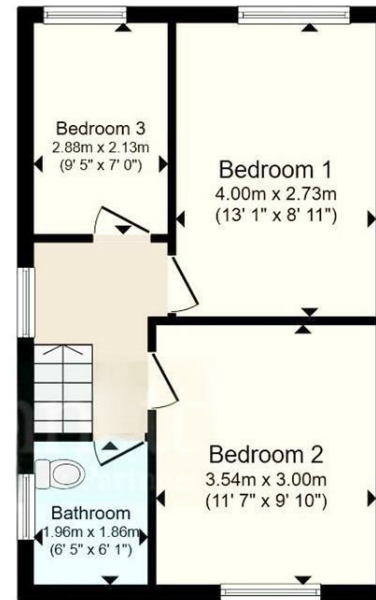

First Floor

Total floor area 84.6 sq.m. (910 sq.ft.) approx

This floorplan is for illustrative purposes only and is not drawn to scale. Measurements, floor-areas, openings and orientations are approximate. They should not be relied upon for any purpose and do not form any part of an agreement. No liability is taken for any error or mis-statement. All parties must rely on their own inspections.

**FOR MORE INFO AND
TO SEE OUR OTHER
LOVELY PROPERTIES
CHECK OUT OUR WEBSITE**

MOVEWITHEDWARDS.CO.UK

**HAVE YOU GOT
A PROPERTY
TO SELL?
WE'D LOVE TO
HAVE A CHAT
01789 414222**

**DID YOU KNOW WE ALSO
DO MORTGAGES.
FOR FREE ADVICE
SPEAK TO
ONE OF OUR
CONSULTANTS**

