



# FOR STARTERS



ASKING PRICE  
£415,000

## MAIN COURSE

This stunning two double bedroom Victorian terrace is situated in the highly sought-after area of Tiddington, known for its local shops, restaurants, and pub. The property has been meticulously renovated and extended to create a fabulous contemporary home with a generous garden, offering a perfect blend of character and modern living.

The open-plan kitchen/dining room is a real showstopper, featuring bifold doors that overlook the rear garden, a central island, and Velux windows that flood the space with natural light. The shaker-style units, topped with quartz surfaces, provide a stylish and functional space, and the kitchen comes fully equipped with integrated appliances, including an oven, hob, cooker hood, fridge/freezer, dishwasher, and washing machine. There's plenty of room for a dining table or seating area, making it an ideal spot for entertaining.

Upon entering the property, you're greeted by a spacious lounge with a working log burner, adding a cosy touch and creating a lovely atmosphere. The ground floor also includes a contemporary WC and access to a well-sized cellar from the lounge, which benefits from good head height making it perfect for storage.

Upstairs, the two double bedrooms are impressive. The front bedroom features a charming fireplace and an en-suite shower room, complete with a large walk-in shower and drencher head, fully tiled for a sleek finish. The master bedroom, overlooking the rear garden, boasts a



vaulted ceiling, enhancing the sense of space and light, and comes with a full en-suite bathroom with a bath and shower over.

Outside, the rear garden has been beautifully landscaped, offering a large patio area directly off the kitchen—ideal for outdoor seating. The remaining garden is laid to lawn and includes a garden shed. While parking is on-street, it's readily available without the need for a permit.

With its perfect blend of period charm and contemporary living, and within walking distance of local amenities, this house will appeal to a wide range of buyers.

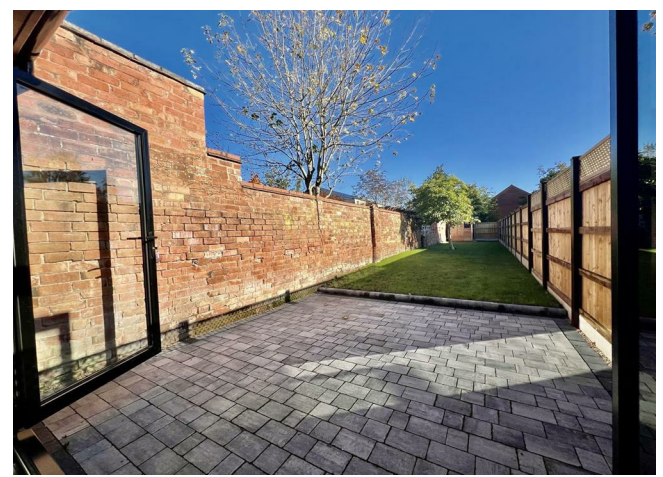

# KEY INGREDIENTS

 Tenure  
Freehold

 Council Tax  
Band - C

 EPC  
Band - C

 North East

 All mains services  
connected

 Heating System  
Gas



Alveston Primary

**WHY NOT TAKE  
A LOOK INSIDE?  
GIVE US A CALL  
01789 414222**



### Ground Floor

Approx. 47.1 sq. metres (506.5 sq. feet)

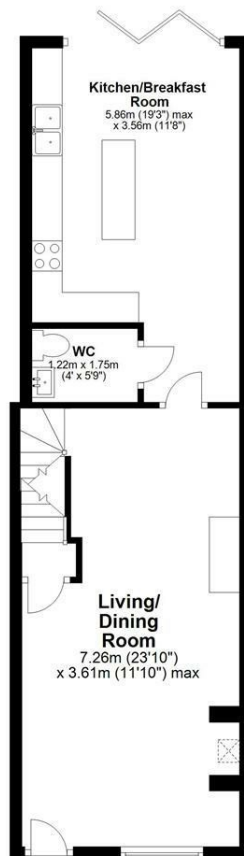

### Basement

Approx. 8.2 sq. metres (88.7 sq. feet)

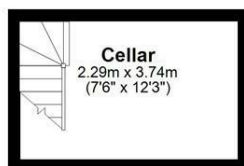

### First Floor

Approx. 40.5 sq. metres (435.7 sq. feet)

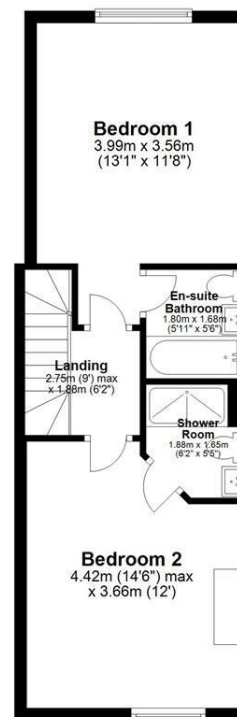

Total area: approx. 95.8 sq. metres (1031.0 sq. feet)

Floor plans are intended to give a general indication of the proposed layout. Details and measurements within are not intended to form part any contract.  
Plan produced using PlanUp.

FOR MORE INFO AND  
TO SEE OUR OTHER  
LOVELY PROPERTIES  
CHECK OUT OUR WEBSITE

[MOVEWITHEDWARDS.CO.UK](http://MOVEWITHEDWARDS.CO.UK)

HAVE YOU GOT  
A PROPERTY  
TO SELL?  
WE'D LOVE TO  
HAVE A CHAT  
01789 414222

DID YOU KNOW WE ALSO  
DO MORTGAGES.  
FOR FREE ADVICE  
SPEAK TO  
ONE OF OUR  
CONSULTANTS

